

Redline DRR (Double Reversing Rotary Table)

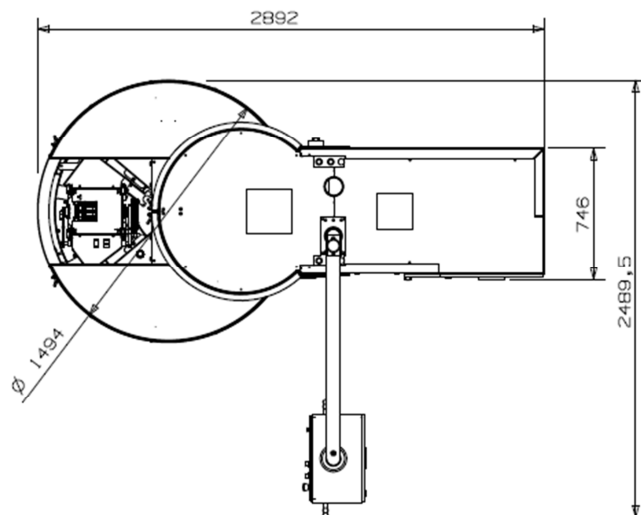

Technical information	
Length	2900 mm
Width	2500 mm
Height	3500 mm
Weight	5500 kg
Processing power	11 KW
Connection power	approx. 20 KW
FLAKKO unit	1
Tools per unit	3
Single stroke of tools	50 mm
FLAKKO tool diameter	230 mm
Processing width	300 mm
Processing length	100 mm
Graduated circle circular carriage (double reversing)	800 mm
Number of circular carriages (double reversing)	2 (separate)
Feed	0.2 - 10.0 m/min
Loading and unloading method	Manually or robot handling
Processing method	Wet or dry flakkoting

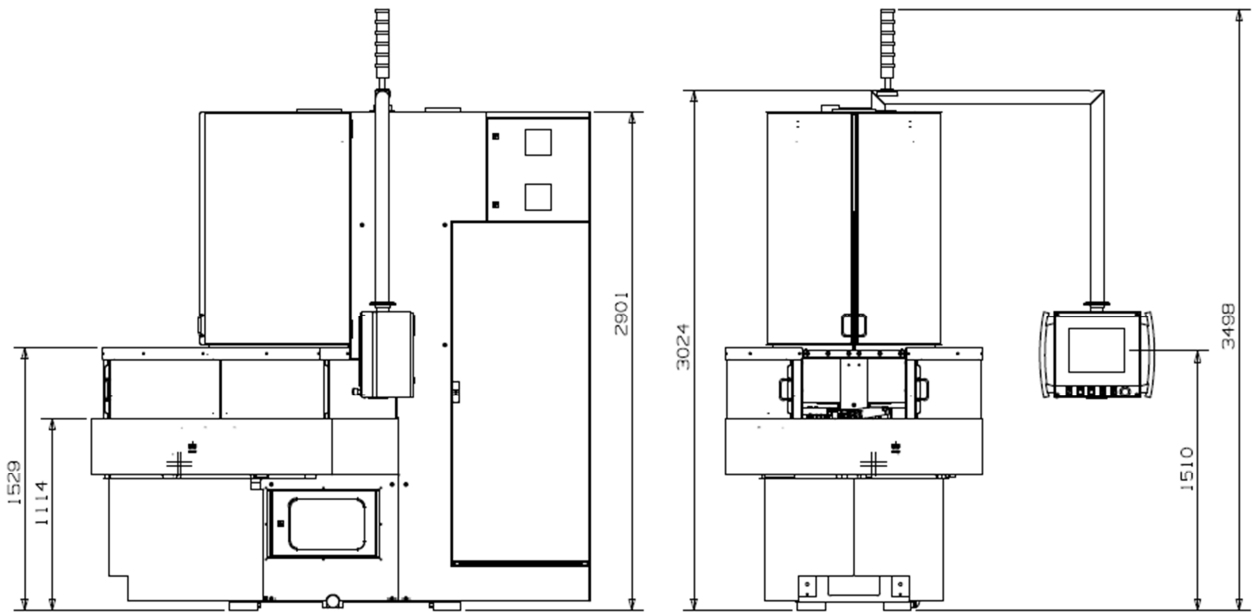

Typical applications:

Deburring and edge preparation of precision parts, e.g. nozzle bodies, anchor plates, gear wheels, as well as all kinds of cutting tools with appropriate mountings

Delivery time: 8 to 10 months

Price segment: Available on request

Customer benefits:

- The 3 tools can be individually extended and retracted, making the machine suitable for multi-stage processing
- Acoustic emission system (AES) supports probing by the FLAKKOTIER tool
- Machine can be highly automated (handling)
- Central and ergonomic touchscreen operation for all controls and information
- Return on investment for some customers after 1-2 years of operation
- Machine can be operated for wet machining, optionally for dry machining
- Low operating and maintenance costs
- FLAKKOTIER tool database
- Customer workpiece database

Customised modifications (*examples*)

- With or without PROFIN handling cell
- Workpiece mounting adapted to customer needs
- Processing material pumping station with vapour extraction as system extension
- FLAKKO power unit with program-controlled spindle stroke adjustment
- RFID tool monitoring
- Processing material vapour extraction
- Processing material filtering system

07.03.2013, tgy